

Installation Instructions

Note: Be sure to shut off the water supply and remove your toilet tank according to original manufacturer's instructions before proceeding with this installation.

A. Dual Flush Valve Mechanism Installation

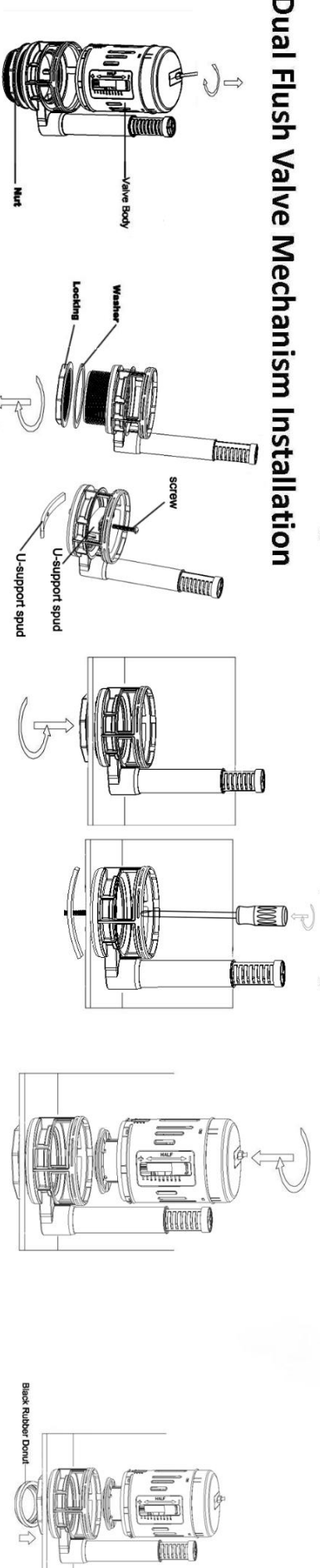

1. Hold the base of the flush valve and rotate body counter-clockwise to separate it from the base.

2. Remove the hex nut and nut collar from the flush valve base. DO NOT remove the seal!

3. Insert the flush valve's base into the water tank. Screw on the nut collar and hex nut. Snug it up tight with your hand.

4. Take the body of flush valve and set it into the base and lock in place by rotating it clockwise.

5. Insert the tank to bowl rubber gasket onto the flush valve's outlet bottom.

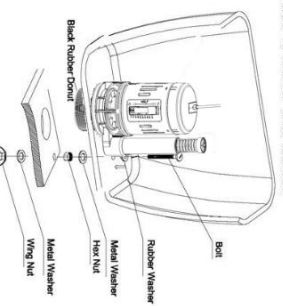

6. Fasten the tank to bowl. Use new bolts/nuts if needed. Make sure the bolts have the black rubber washer under the bolt's head.

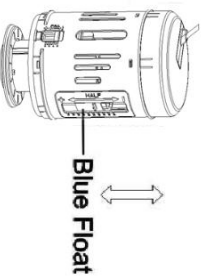

7. Adjust the half flush volume by sliding the blue flow adjuster up or down. When the float is higher, the discharge water volume is less. Slide the flow adjuster down a little to arrive at the correct amount of water needed for the ½ flush.

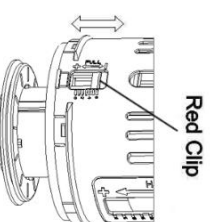

8. Adjust the full flush volume by adjusting the red flow adjuster. When the float is higher, the discharge water volume is less. Slide the flow adjuster down to arrive at the correct amount of water needed for a full flush.

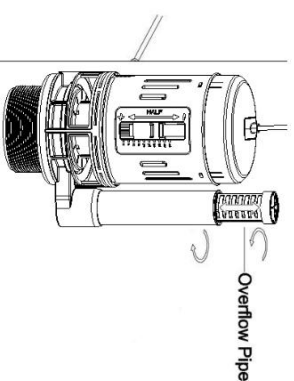

9. Adjust the overflow pipe to correspond with the bowl fill tube so that tube is above the water line when tank is full.

B. Flush Handle Installation

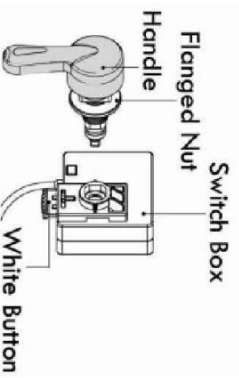

1. Depress the blue button on the flush handle switch box to pull handle out.



2. Unscrew the flanged nut from the handle body and move the square rubber seal.

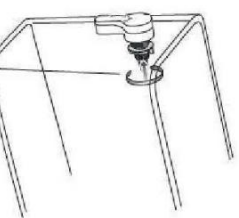

3. Insert square tank seal into square hole on tank.

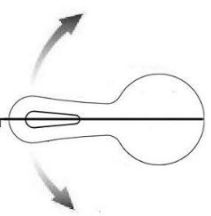

4. Make sure handle is in vertical position; it swings left/right approx 90 degrees.

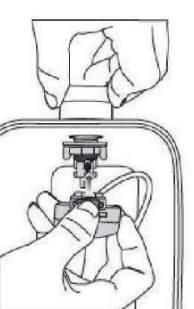

5. Important!! Align the grooves on the handle mechanism in vertical position (see picture).

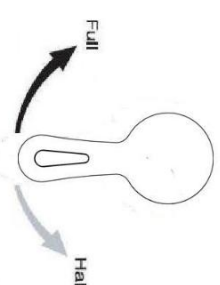

6. Left is full flush/ right is half flush.